

Arco Air



230V, 50-60Hz, Max 8 W LED GU10, Class I, IP54



NO: Kan kun installeres av en registrert installasjonsvirksomhet
 EN: Only to be installed by an authorized electrician
 FR: Doit être installé par un électricien autorisé
 NL: Mag alleen geïnstalleerd worden door een bevoegde elektricien
 DE: Dieses Produkt darf nur durch autorisiertes Personal (z. B. Elektro-Installateur) angeschlossen und in Betrieb genommen werden.

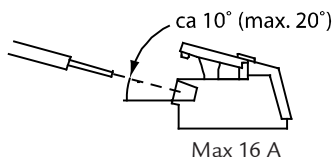
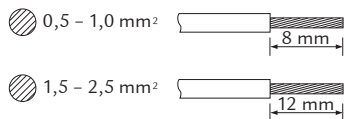
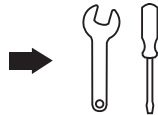

Bollard:

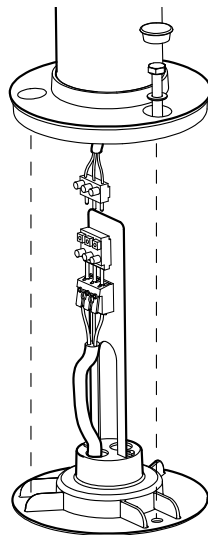
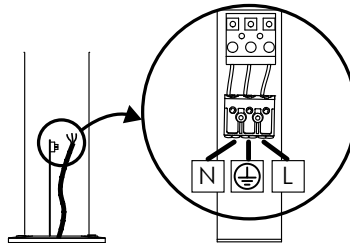

Alternatives for anchoring:

Alt. A :

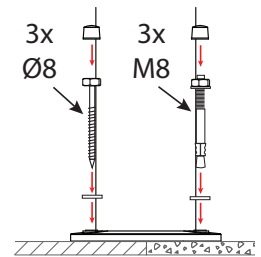

Alt. B :

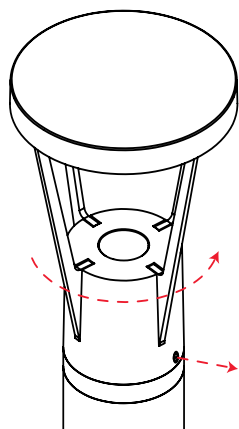
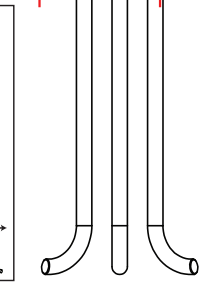
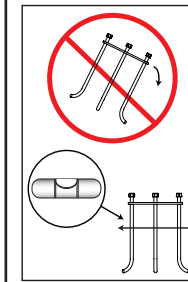
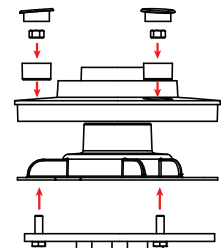

Wall:

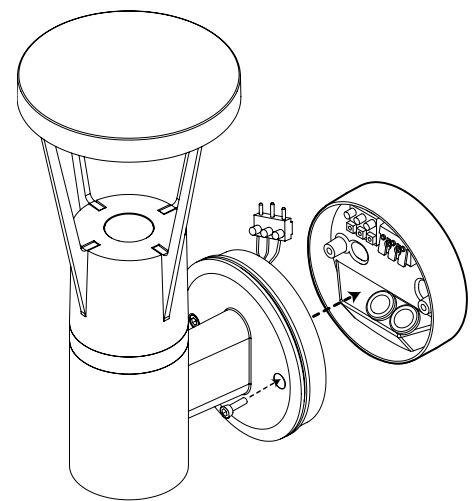
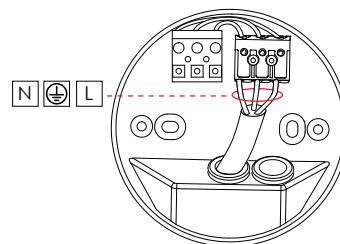
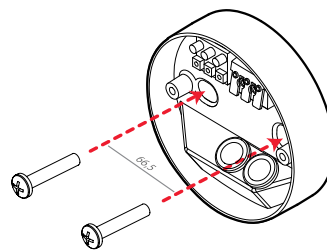

SG Armaturen AS
 Svåbekk 15
 N-4790 Lillesand
 NORGE
 Tel: +47 37 500 300
 www.sg-as.no

SG Armaturen AB
 August Barksg. 30B
 SE-421 32 Västra Frölunda
 SVERIGE
 Tel: +46 31 81 71 10
 www.sg-ab.se

SG Lighting SA/NV
 Wayenborgstraat 4
 B-2800 Mechelen Noord II
 BELGIQUE/BELGIË
 Tel: +32 (0) 15 20 72 71
 www.sglighting.net

SG Lighting SA/NV
 Parc de l'Arboretum
 73 rue de Saint Mandrier
 83140 Six Fours Les Plages
 FRANCE
 Tel: +33 04 94 93 00 00
 www.sglighting.net

SG Leuchten GmbH
 Nordstrasse 53
 D-59399 Olfen
 DEUTSCHLAND
 Tel: 0152-57000500
 www.sg-leuchten.de